

Harry Ward.

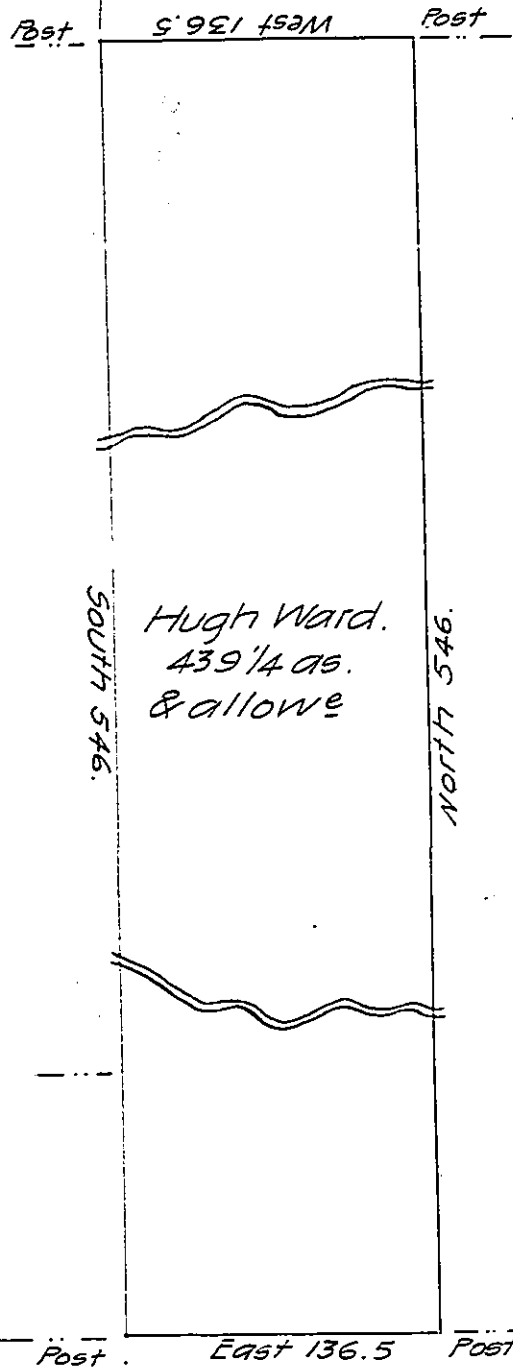

Wm. Huff.

Henry Ward.

Paul Ward.

Jedediah Reed.

Situated on the waters of Tonollaway Creek in Bethel Township Bedford County Containing 439 1/4 acres with the usual allowance of Six Per Cent for Roads &c. Surveyed for Hugh Ward the 11th day of October 1794, on warrant dated the 21st day of February 1794.

George Woods Jurr. D.S.

To Daniel Brodhead Esqr. S. G.

Examined by me December 15th 1808.

John Anderson Deputy Surveyor.

To Samuel Cochran Esqr.
Surveyor General.

IN TESTIMONY that the above is a copy of the original remaining on file in the Department of Internal Affairs of Pennsylvania, made conformably to an Act of Assembly approved the 16th day of February, 1833, I have hereunto set my Hand and caused the Seal of said Department to be affixed at Harrisburg, this twenty-seventh day of September 1907

Henry Houch
Secretary of Internal Affairs.